



- Aluminum housing, anodized surface, benefits for cooling and durability
- Backplane design compatible for SAS/SATA II drives
- Built-in fans for self-contained ventilation
- Individual Key lock of each HDD tray for physical security
- LED indicators for power and activity on each tray
- Temperature and Fan failure LEDs and mutable buzzer alarm

Overview

Netstor's 750/760 series is a stylish 4/8 bay, hot-swappable, SAS/SATA compatible external enclosure. The housing made from an elegant aluminum with anodized surface for maximum cooling, and the structure made from heavy duty material for solid protection on drives. The 750/760 series is built-in directly SAS/SATA backplane design with no internal cable for best performance and superior airflow. Moreover, the host connection is designed with the new

interface technology of Multi-lane (SFF8470) in up to 10Gbps bandwidth for 4-disks in single connectivity.



Enclosure Management

Each hot-swap tray of NS750S/NS760S series provides power and activity LED indicators for each single Hard Disk, and the enclosure is built-in with ultra-quiet cooling. And environment detecting features with LEDs and mutable buzzer alarm for fan-fail and over temperature for user friendly.



Easy Configuration for Raid Function

Through connection with Host Raid HBA, the 750/760 JBOD enclosure is easy to be configured with Raid level for reliable data protection, and to run high speed data throughput for Video Editing or Content Creation application. The JBOD enclosure is compatible any standard PCI-X or PCI-e Raid HBA with two port external miniSAS or Multilane connectors.

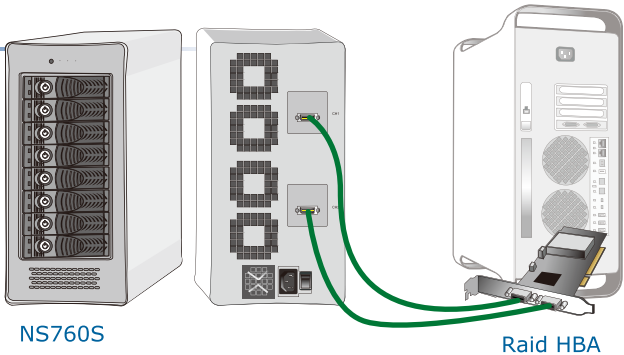

Optional Accessories

Cable - AAMSM1

MultiLane Screw (SFF8470) to miniSAS (SFF8088), Length: 1m

For Host Connector miniSAS (SFF8088)



Cable - AAMSS1

MultiLane Screw (SFF8470) to MultiLane Screw (SFF8470), Length: 1m

For Host Connector MultiLane Screw (SFF8470)



Specifications

Model	NS750S	NS760S
Form-Factor	Desktop 4 bay	Desktop 8 bay
Host Interface	Single Multilane(SFF8470)	Dual Multilane (SFF8470)
HDD Interface	SAS/SATA (3Gbps)	
No. of Disk(s)	Up to 4	Up to 8
Raid Function	JBOD	
LED Display for each Tray	White- Power ON indicator , Blue- Busy (HDD Accessing) indicator	
LED Display for Enclosure	Power-On LED – White , FAN Normal –Green ; FAN Fail – Red TEMP. Normal-Green ; TEMP. over 55℃ - Red	
Material	Aluminum Housing and Plastic Front Panel	
Power Supply	220W (High reliability IPC-grade) 100-240V AC, 50/60Hz Universal	300W (High reliability IPC-grade) 100-240V AC, 50/60Hz Universal
Cooling	Two 60x60x15mm Hot-Swappable Cooling Fans	Four 60x60x15mm Hot-Swappable Cooling Fans
Alarm	Buzzer Beeping for Fan-fail or over temperature(over 55℃) occurs	
Dimension	231(D) x 156(W) x 209(H) mm 9.1(D) x 6.1(W) x 8.2(H) inch	231(D) x 156(W) x 310(H) mm 9.1(D) x 6.1(W) x 12.2(H) inch
System Requirement	An external miniSAS or Multilane port	Two external miniSAS or Multilane ports
O.S Support	OS Independent	

